



Making Your Job More Enjoyable

Bluetooth Pressure Probe
with Digital Display

VSP1



VALUE Mechanical & Electrical Products CO., LTD

Add: No 5, 3rd. Street, East Industrial Park, Wenling, Zhejiang, China

Tel: +86-576-86191959

Email: value@worldvalue.cn

www.worldvalue.cn

Ver. No.: Y2025M05

VALUE • Quality Assurance



CONTENTS

I. Safety Information	01
II. Product Overview	02
III. Technical Specification	02
IV. Screen Display	03
V. Indicator Light	04
VI. Bluetooth Connection	05
VII. Device Standby/Off	05
VIII. Temperature End Indication	05
IX. Button Function	05
X. Exploded View	06
XI. Download Methods	07
XII. Login Methods	07
XIII. Page Introduction	08



Warning

This product operates under high pressure. Follow all safety guidelines regarding refrigerant handling including wearing Personal Protective Equipment such as safety glasses, and gloves.



Warning

This product contains a built-in lithium-ion battery.

- Do not disassemble, puncture, crush, or expose the battery to fire, high temperatures, or water.
- Use only the provided or compatible charger specified in the manual.
- Improper handling of the battery may cause fire, explosion, or serious injury.
- Dispose of the product following local regulations. Do not dispose of it with household waste.

Dispose of this product correctly



This mark indicates that this product should not be disposed of with other household waste. It is important to prevent uncontrolled waste disposal that may be harmful to the environment or human health, please use a return and collection system or contact the retailer from whom you purchased the product. They can recycle this product in an environmentally safe manner.

I. Safety Information

Please read this manual carefully before operating, servicing, or maintaining the product. Doing so will help ensure long-term stable performance and provide a comprehensive understanding of the safety considerations and precautions associated with its use and operation.

Please carefully check if the product you received matches the one you ordered and ensure that the accessories and instruction manual are included. In addition, inspect for any damage that may have occurred during transportation. If you notice any of these issues, kindly contact our marketing department or local distributor promptly. Reading the manual carefully and following the correct operating procedures will help ensure safe usage and extend the equipment's service life. Follow these guidelines to prevent personal injury or death:

- Most governments and regulatory authorities require HVAC technicians to be trained and certified in the safe and proper operation of HVAC tools, such as this instrument. Proper training is essential for the safe use of this instrument, as it can be connected to various types of equipment through tubing and fittings.
- Read the entire user manual before using the instrument.
- Use the instrument only as specified in this user manual. Failure to do so may impair the protection provided by the equipment.
- Before using the instrument, inspect the case for any cracks or loose components. Do not use the instrument if it is damaged.
- The instrument contains no internal, user-serviceable parts.
- Do not open the instrument.
- Do not use the instrument if it operates abnormally, as this may impair its protection. If in doubt, have the instrument serviced.
- Do not operate the instrument near explosive gases, vapor, or dust.
- Ensure proper safety measures when connecting to piping that contains refrigerant.
- The test pressure must not exceed the specifications outlined in this manual.

II. Product Overview

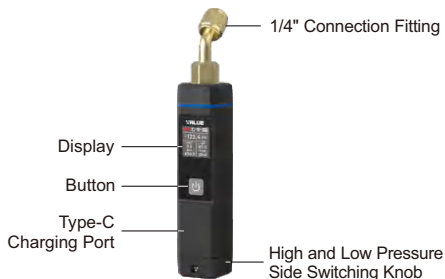

III. Technical Specification

Model	VSP1
Location	Indoor/Outdoor
Altitude	≤5000m
Charging Temperature	0~43°C
Discharge Temperature	-10~50°C
Measuring Range	-29~725 psi
Measuring Accuracy	±0.5% Full range
Resolutions	0.01 psi
Working Environment	-10-50°C, <75% RH
Battery	3.7V 1200mAh lithium battery
Bluetooth Range	164 ft (50m) line of sight

IV. Screen Display

Pressure Interface:

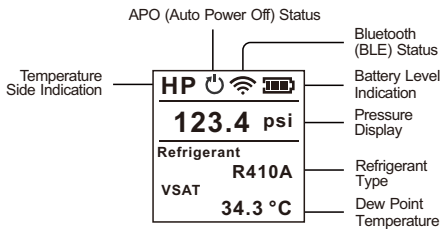

Pressure Interface:

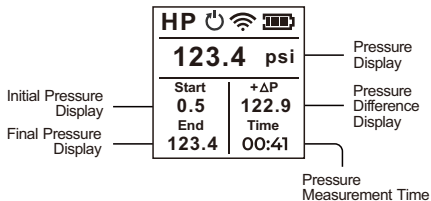

Parameter Setting Interface:

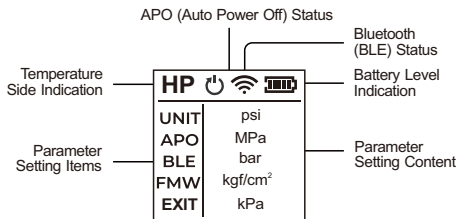



Parameter Setting Items	Parameter Setting Content
UNIT (Pressure unit)	psi, MPa, bar, kgf/cm ² , KPa
APO (Automatic power off)	ON, OFF
BLE (Bluetooth switch)	ON, OFF
FMW (Hardware information)	VER: Hardware version; MAC: Bluetooth address
CAL (Calibrate)	YES: Start zero calibration; EXIT: Cancel zero calibration
EXIT (Exit Project)	Return to home screen

V. Indicator Light

1. Power Status
 - Powered On: Green light stays on.
 - Powered Off: Red light stays on.
2. Screen-On Mode
 - Green light blinks when buttons are pressed.
3. Screen-Off Mode
 - Bluetooth Connected: Green light flashes.
 - Bluetooth Not Connected/Broadcasting: Yellow light flashes.

VI. Bluetooth Connection

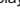
- Bluetooth Disconnected or Broadcasting: The  Bluetooth icon blinks on the display.
- Bluetooth Connected: The  Bluetooth icon remains steady.
- Bluetooth Off: The  Bluetooth icon is not displayed.

VII. Device Standby/Off

The device will automatically enter standby mode and turn off the screen after 1 minute of inactivity. It will automatically power off if it has not been operated for 2 hours.

VIII. Temperature End Indication

Rotate the rotary knob fully to the left to display the LP side on the device.

Rotate the rotary knob fully to the right to display the HP side on the device.

IX. Button Function

Power on/off: Press and hold the button for at least 2 seconds to turn the power on.

To turn it off, press and hold the button for at least 2 seconds.

Function operation - Main interface:

1. In Interface I, display the pressure value. After connecting the APP, display the refrigerant type and the corresponding saturation temperature (dew point).
2. In Interface I, click the button to switch to Interface II, record the initial pressure value, and start the timer.
3. Click the button in the previous state to record the final pressure value and stop the timer.
4. Click the button in the previous state to return to Interface I.
5. Double-click on the main interface to enter the parameter interface.

Function operation - Parameter interface:

1. In the parameter interface, click to cycle through the left-side parameter setting items. The order is:
 - Pressure Unit
 - Auto Power Off (APO)
 - Bluetooth (BLE)
 - Device Information
 - Calibrate (CAL)
 - Exit Project (EXIT)
2. Double-click to access the right-side parameter setting options.
3. Click to switch the parameter option, then double-click to confirm.

CAUTION:

1. If the device is in a ventilated state but the screen display is not 0, use the zero-point calibration function to improve measurement accuracy.
2. When measuring vacuum pressure, units will automatically switch to inHg, and the screen will display negative pressure values. These values are for reference only.

X. Exploded View

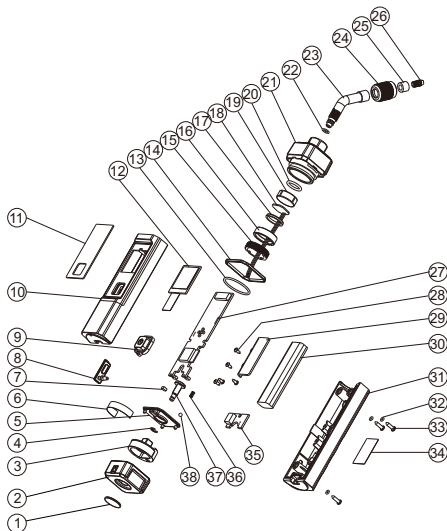

Spare Parts List

No.	Item	No.	Item
1	Decorative Cover Plate	17	Plastic Pressure Ring
2	Square knob	18	Sensor PCB
3	Fixed Seat	19	Ceramic Pressure Sensor
4	Opening Retainer	20	O-Ring
5	Knob Cover	21	Top Cover
6	Logo Label	22	O-Ring
7	Magnet	23	45° Angled Mandrels
8	Rubber Stopper	24	Mandrel Nuts
9	On/Off Button	25	Rubber Seal
10	Front Cover	26	Valve Core Press Studs
11	Transparent Window	27	Main PCBA
12	Display	28	Self-Tapping Screws
13	O-Ring	29	Battery Plate
14	Decorative Ring	30	Lithium Battery
15	T-Bronze Pressure Ring	31	Back Cover
16	Copper Spacer	32	O-Ring

No.	Item	No.	Item
33	Self-Tapping Screws	36	Spring
34		37	Retaining Stud
35	Charging Adapter	38	Balls

XI. Download Methods

For Apple:

Search for "myNAVAC" in the App Store, then download and install the app.



iOS Download
(iOS 12.0 or above)

For Android:

Search for "myNAVAC" in the Google Play Store, then download and install the app.



Android Download
(Android 7.0 or above)

XII. Login Methods

Account login:

A network connection is required. All data records are stored on the server.

Visitor mode:

No network connection is required. All data records are stored locally on the cell phone.

XIII. Page Introduction

1. Connecting the Device

1.1 Turn on your phone's Bluetooth and power on your device. On the main interface, tap the "+" icon next to "Add Your Device" to start searching for devices.

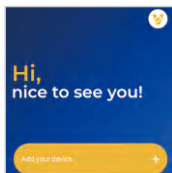

1.2 Locate the target device to be connected, tap the "+" in the upper right corner, and wait for the connection to be established.

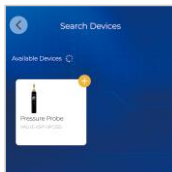

1.3 Once successfully connected, tap the device icon to access the device interface.

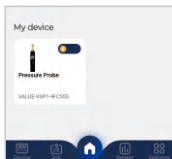

1.4 After the first successful connection, subsequent connections only require turning on the device. When the corresponding product box under "My Devices" changes from gray to bright, tap "Info" to successfully establish the connection.

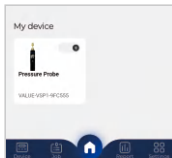

2. Device Main Interface

2.1 After entering the device main interface, use the product to perform pressure detection: Click Start to begin pressure detection and automatically initiate chart recording. Click Stop to pause the detection and enter standby mode. Click Wait to reset the button to Start. This cycle can be repeated to perform segmented pressure detection. Temperature units can be selected from the dropdown menu in the temperature value display area ("C"/"F"). The refrigerant type can be modified by clicking the refrigerant display area to access the selection page.

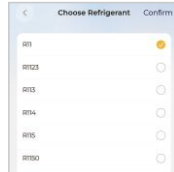

2.2 Settings Page: You can set the pressure units, enable/disable the device's APO, and upgrade the device firmware.

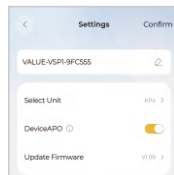

3. Device Information

3.1 Tap "Info" from the bottom navigation bar to access the device information page, where you can view device's relevant details.

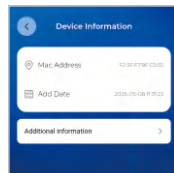

4. Data Recording

4.1 Tap "Record" from the bottom navigation bar to access the data recording interface. Tap "●" to start recording data, and tap "●" to stop the recording and generate a report.

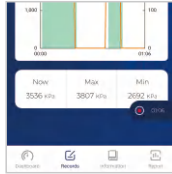

5. Viewing Test Reports

5.1 Tap "Report" from the bottom navigation bar to view the current device's test reports.



5.2 Tap "📊" on the home page to view test reports for all devices.



5.3 Select the desired test report to open the report page, then tap the "Share" button. A pop-up window will prompt you to select the file type and interval for the test report.

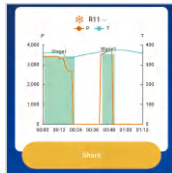

5.4 Once the file type and interval are confirmed, a data table will be automatically generated. Tap "🔗" in the upper right corner to share the test report.

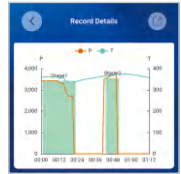

This image shows a blank sheet of white paper with horizontal ruling lines. The lines are evenly spaced and run across the width of the page. There are no margins, text, or other markings on the paper.[illegible]